

1099/8

1123/1

221-198

(8.26)

51

9.70

3

1099/27

(14.12)

221-253

1099/22

7

14.00

2

1.70

18/3

18/1

18/2

212-22

1099/3

10.20

22

166-5

211-296

27

14

3.10

16

15

9.30

24

17.25

8.05

26

25

0.65

(0.65)

211-284

15

1101/1

⊕
44/2

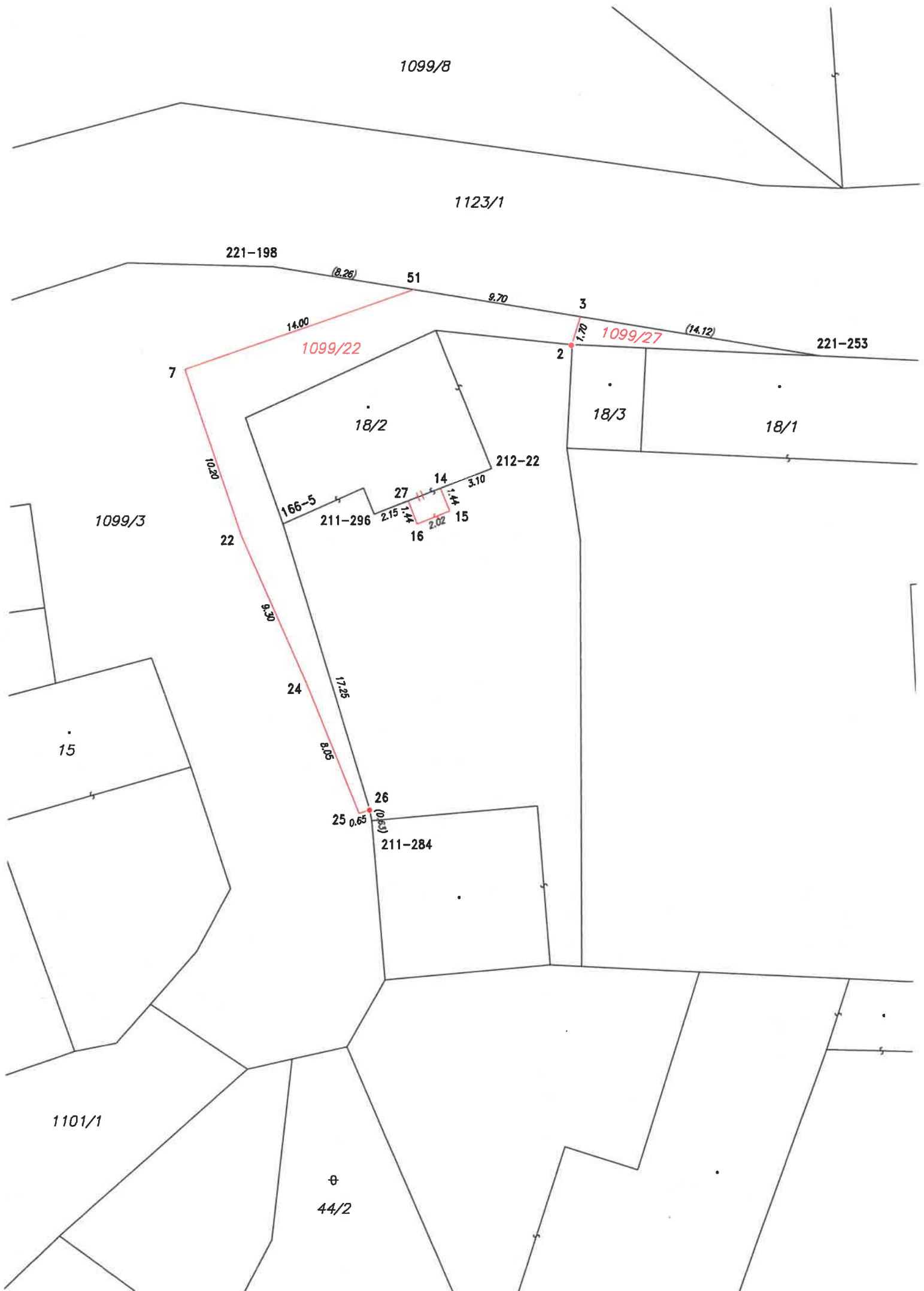

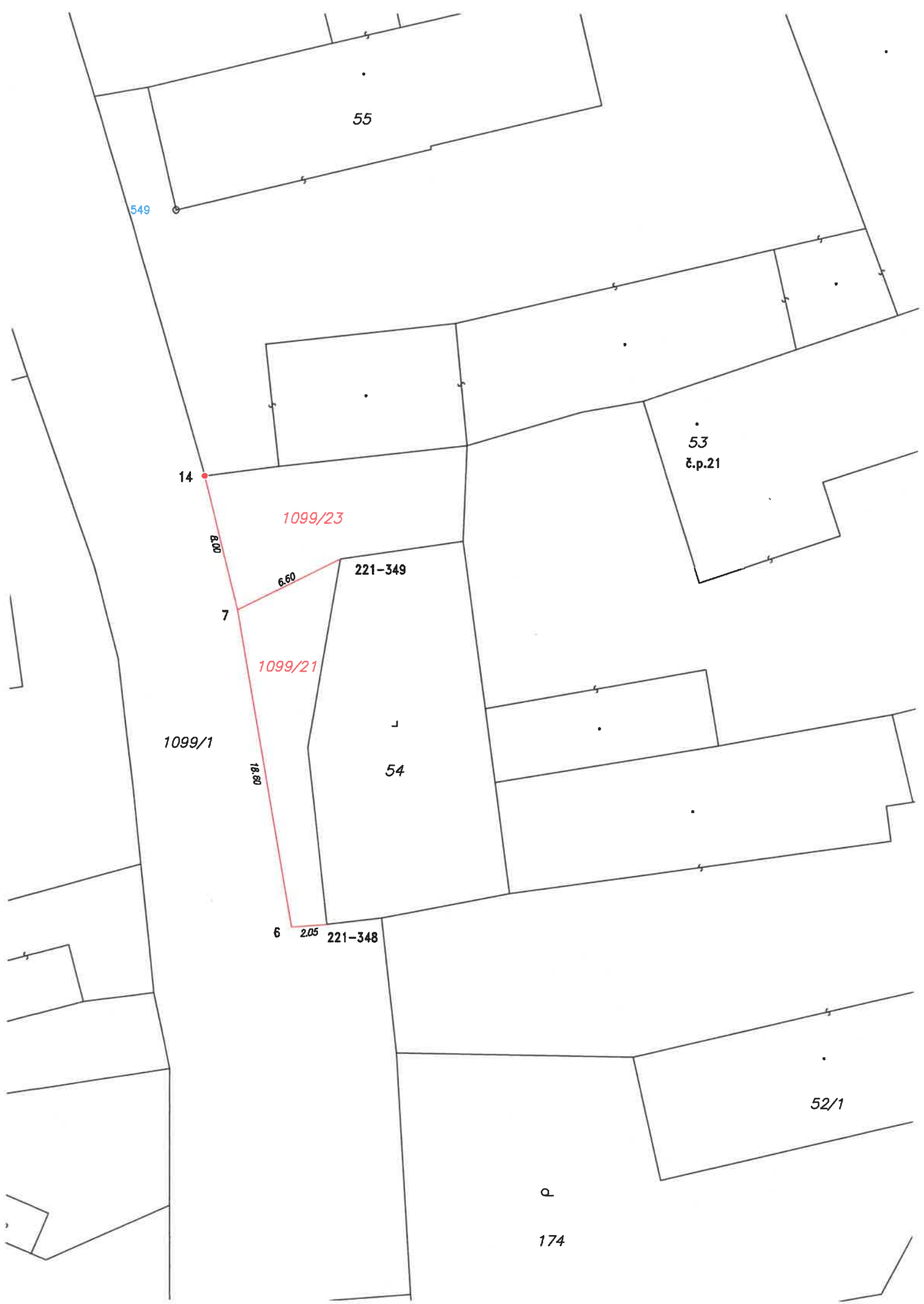

55

549

53
č.p.21

14

1099/23

8.00

6.60

221-349

7

1099/21

1099/1

18.80

54

6

2.05

221-348

52/1

o

174